

---

First published in the *Government Gazette*, Electronic Edition, on 6th February 2001 at 5:00 pm.

---

**No. S 62**

**PROTECTED AREAS AND PROTECTED PLACES ACT  
(CHAPTER 256)**

**PROTECTED PLACES (NO. 2) ORDER 2001**

**ARRANGEMENT OF PARAGRAPHS**

Paragraph

1. Citation and commencement
  2. Premises declared to be protected place
- The Schedule

---

In exercise of the powers conferred by section 5 (1) of the Protected Areas and Protected Places Act, the Minister for Home Affairs hereby makes the following Order:

**Citation and commencement**

**1.** This Order may be cited as the Protected Places (No. 2) Order 2001 and shall come into operation on 7th February 2001 and remain in operation until 13th February 2001.

**Premises declared to be protected place**

**2.** The premises described in the second column of the Schedule are hereby declared to be a protected place for the purposes of the Protected Areas And Protected Places Act, and no person shall be in those premises unless he is in possession of a pass-card or permit issued by the authority specified in the first column of the Schedule or has received the permission of an authorised officer on duty at the premises to enter the premises.

---



---

 THE SCHEDULE
*First column*

The Authority

Assistant Chief of the  
General Staff (Training),  
G6 Army

*Second column*

Protected Place

Haig Road Camp.

All that area comprised in part of State Land Lots 55-30, 55-31 and 55-32 in MUKIM No. 25 (GELANG) occupied by "HAIG ROAD CAMP" containing an area of about 14,204 square metres and bounded approximately as follows:

Commencing at a point northernmost corner of the aforesaid "HAIG ROAD CAMP" which point is 32,230.403 metres North and 35,245.086 metres East of the Survey Department origin of co-ordinates (30,000 metres North, 30,000 metres East), the boundaries run along successive lines of bearings and distances approximately as under:

<i>Bearing</i>	<i>Distance in metres</i>
156°11'21"	11.157 (along existing fence)
153°42'16"	16.645 (along existing gate)
157°59'35"	52.282 (along existing fence)
244°47'31"	20.491 (along existing fence)
159°58'36"	0.598 (along existing fence)
248°16'53"	1.736 (along existing fence)
308°37'11"	0.580 (along existing fence)
246°28'41"	62.393 (along existing fence)
246°41'23"	41.991 (along existing fence)
247°21'05"	53.520 (along existing fence)
336°38'45"	8.933 (along existing fence)
336°36'16"	12.197 (along existing fence)
336°09'45"	11.669 (along existing fence)
336°34'52"	42.661 (along existing fence)
64°40'14"	21.698 (along existing fence)
65°34'39"	1.474 (along existing gate)
65°03'23"	56.093 (along existing fence)

---



---

 THE SCHEDULE — *continued*
*First column*

The Authority

*Second column*

Protected Place

*Bearing**Distance in metres*

65°42'26"

27.207 (along existing fence)

65°06'20"

74.458 (along existing fence)

to the point of commencement.

The boundaries of “HAIG ROAD CAMP” are more particularly delineated and edged pink on Survey Plan No. 25/01/100/GAZ filed in the office of the Director, Building and Infrastructure, Defence Science and Technology Agency, Singapore.

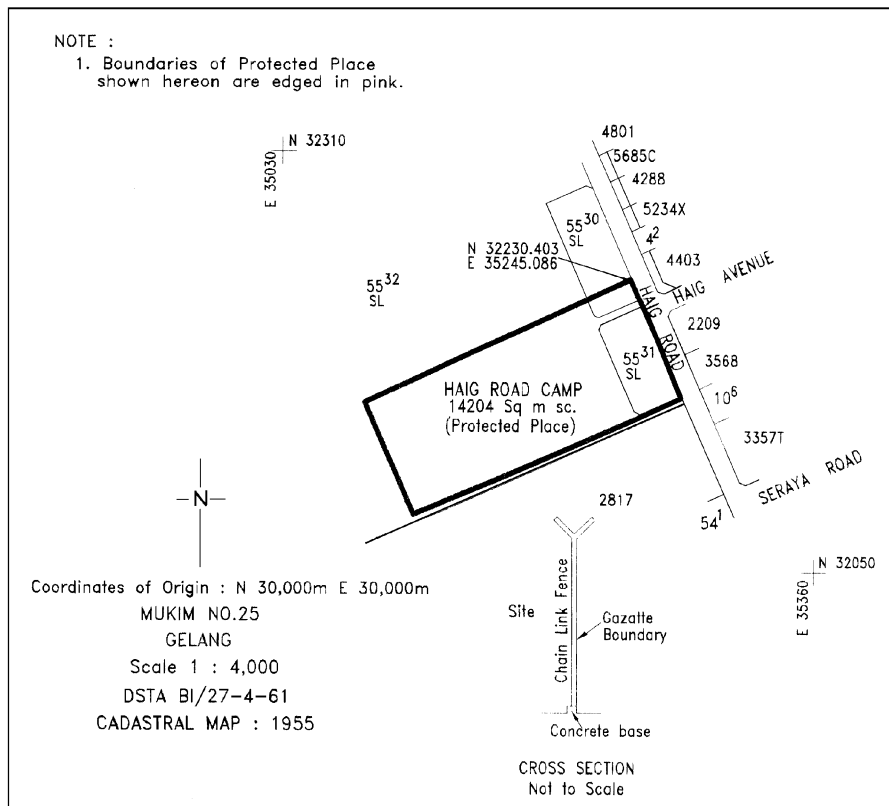
THE SCHEDULE — *continued*

Made this 5th day of February 2001.

TAN GUONG CHING  
Permanent Secretary,  
Ministry of Home Affairs,  
Singapore.

[DSTA BI/ 27-4-61; MHA(PS) 12/2/01 TF 3;  
AG/LEG/SL/256/1997/1 Vol. 2]